

eGate[®] Colour

Description

The particularly friendly welcome

Thanks to the range of colour options available, the upright of the attractive high-tech entrance system matches the store's corporate design and, with the illuminated swivel arm, encourages customers to enter, with the 'barrier-effect' greatly reduced. The barrier effect is greatly reduced.



Features

- Friendly customer reception with LED lighting
- Inviting route guidance in modern design
- Customisation with own logo or lettering available

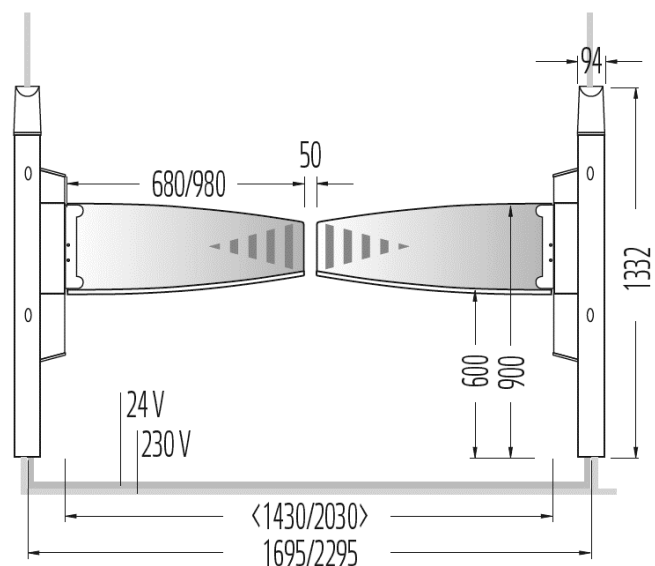
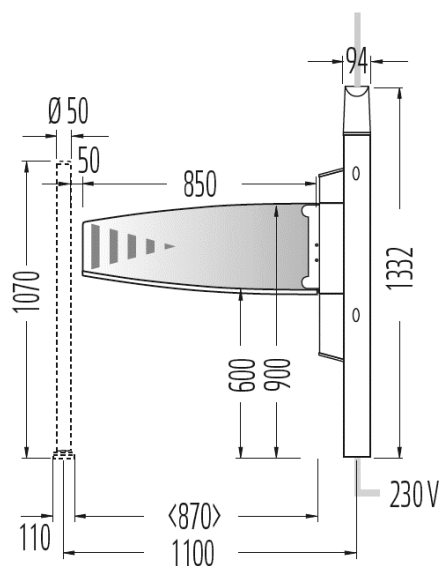

Product equipment:

Design variants	Single system, single- and double-gate, double system, single- and double-gate																																		
Material & surface	Powder-coated aluminium profile																																		
Colour	Standard RAL colours RAL 7016 and RAL 9160 Other RAL colours available on request																																		
Operating status indicator	Integrated LED lighting signals the operating status of the systems in the entry and exit direction																																		
Swivel arm & passage widths	<table border="1"> <thead> <tr> <th colspan="7">Standard-Schwenkarme Höhe x Breite (mm)</th> </tr> <tr> <th rowspan="2">Durchgangsbreite in mm</th> <th colspan="3">Einzelanlage</th> <th colspan="3">Doppelanlage</th> </tr> <tr> <th>714</th> <th>884</th> <th>1014</th> <th>1434</th> <th>1774</th> <th>2034</th> </tr> </thead> <tbody> <tr> <td>Rohr Höhe 300 x</td> <td>680</td> <td>850</td> <td>980</td> <td>680</td> <td>850</td> <td>980</td> </tr> <tr> <td>ESG Höhe 300 x</td> <td>680</td> <td>850</td> <td>980</td> <td>680</td> <td>850</td> <td>980</td> </tr> </tbody> </table>	Standard-Schwenkarme Höhe x Breite (mm)							Durchgangsbreite in mm	Einzelanlage			Doppelanlage			714	884	1014	1434	1774	2034	Rohr Höhe 300 x	680	850	980	680	850	980	ESG Höhe 300 x	680	850	980	680	850	980
Standard-Schwenkarme Höhe x Breite (mm)																																			
Durchgangsbreite in mm	Einzelanlage			Doppelanlage																															
	714	884	1014	1434	1774	2034																													
Rohr Höhe 300 x	680	850	980	680	850	980																													
ESG Höhe 300 x	680	850	980	680	850	980																													
Standard equipment	Adjustable motor speed Barrier manipulation alarm Opening pulse via single radar Potential-free contact, e.g. for fire alarm system Illuminated swivel arm made of toughened safety glass																																		
Optional equipment	Opening pulse via tandem radar Swivel range monitoring in exit section Reverse detection alarm Mains connection Power supply from the ceiling Opening pulse via external peripherals Customisation of the logo or lettering and LED colour																																		

Technical data:*

Power supply	100–240 V
Rated frequency	50 / 60 Hz
Power consumption	Max. 60 W
Rated current	Max. 0.64 A
Recommended mains fuse	10 WD
Protection class	I
Ambient temperature	+10°C to +50°C
Weight	30 kg (without swivel arms)
Level of protection	IP20
Interfaces	RJ45
Drive	24V/DC motor Freely rotatable when power is disconnected
Installation	Concrete foundation C25/30 or ground with a minimum compressive strength of 25N/mm ² , flatness tolerance of +/- 5 mm
Certificates	EN 60335-1:2012/A15:2021; EN 60335-2-103:2015; EN 17352:2022; UL 325:2017/R:2020-02; CAN/UL 325:2017

*Values per column